

This drawing is the property of the Architect and is to be returned if not required for construction. It is not to be used for any other purpose without the written consent of the Architect. The Architect's liability is limited to the professional services provided and does not extend to any other services. The Architect's liability is limited to the professional services provided and does not extend to any other services. The Architect's liability is limited to the professional services provided and does not extend to any other services.

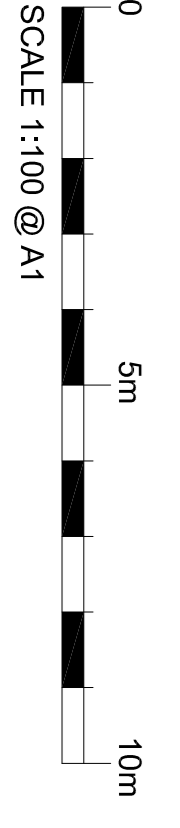
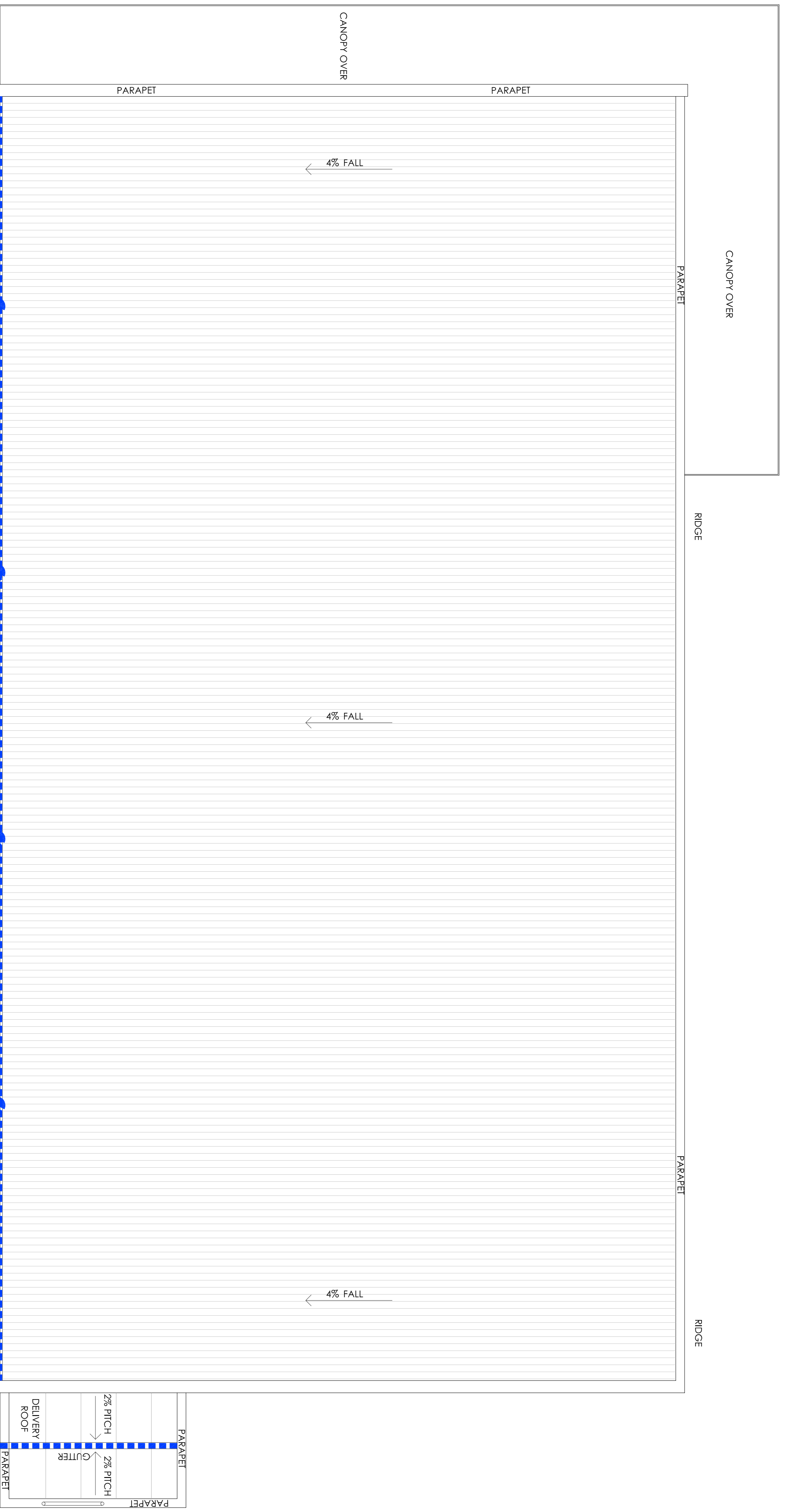

Rev: _____ Date: _____

STATUS: PLANNING

Client
LIDL UK GmbH-Weston-Super-Mare, BS24 7TG

Project
PORTLAND BEACH ROAD,
WEYMOUTH
Title
PROPOSED ROOF PLAN



Job No. 16047
Drawing No. AD112
Drawn by KH
Checked by SN
Date OCT 2017
Scale 1:100
Sheet A1

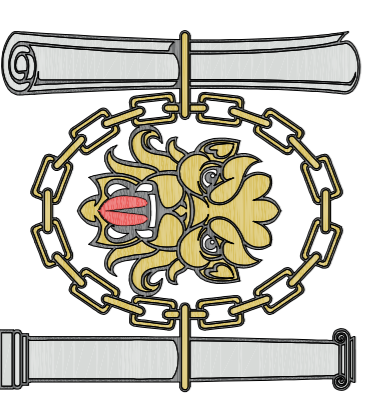

ONE DESIGN ARCHITECTURAL SERVICES
Chartered Institute of
Architectural Technologists
Registered Practise
One Design Architectural Services Ltd
Unit 1, Merchants Quay,
Phase II, Ashley Lane, Shipley
West Yorkshire, BD11 7DB
01274 591188
www.onedesignarchts.com
mail@onedesignarchts.com